

How Do They Connect?

Haunch Connections

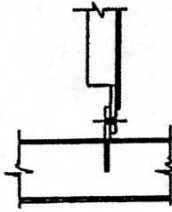

MODELS: 10000
8000-7000-5000
3000-1000

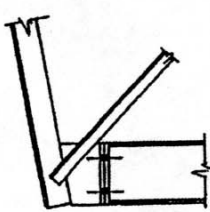
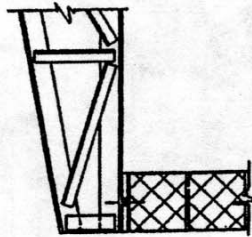

MODEL: 9000

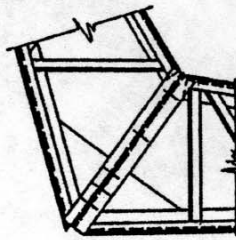

MODEL: 4000

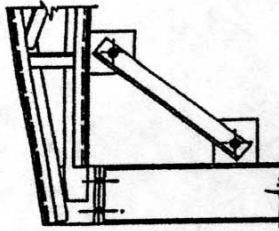

MODEL: 6000

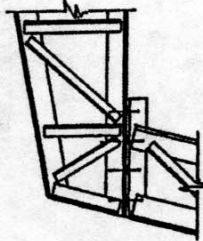

MODEL: 2000

Haunch & Lean-to Connection - End Post Connection

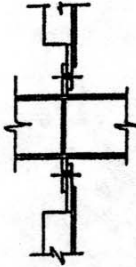
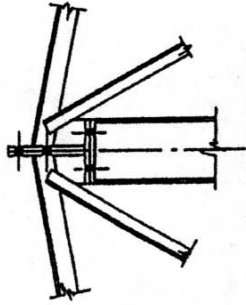

MODEL: 10000

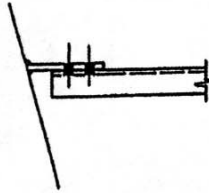

Ridge/Peak Connection

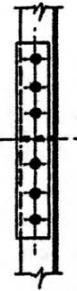
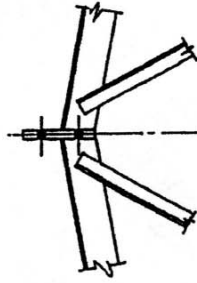

MODELS: 9000
8000-7000-6000
3000-2000

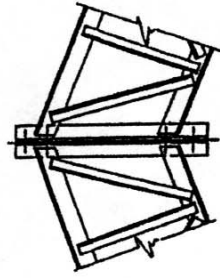

MODEL: 5000
(On single angle
trusses only)

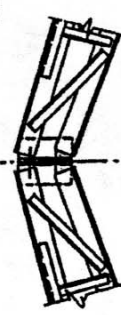

MODEL: 4000

Endpost Connection

Lean-To Connections

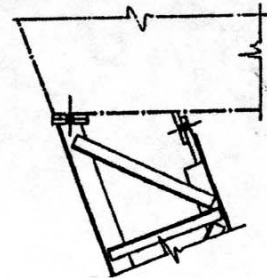

MODEL: 5000

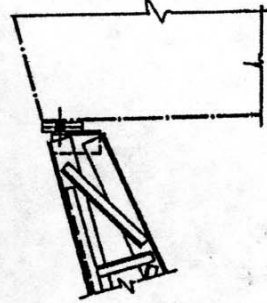

MODEL: 4000

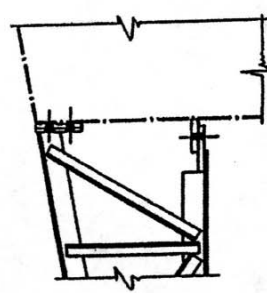

MODEL: 8000-7000
6000

ENDPOST @ EXPANDABLE FRAME

Overhang Connection

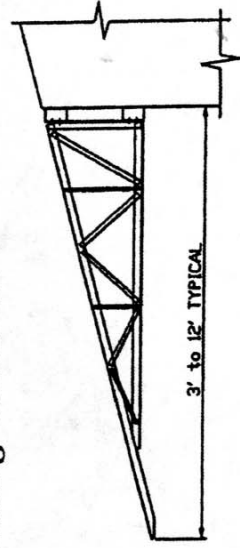

3' to 12' TYPICAL

ENDPOST @ NON-EXPANDABLE FRAME

TOP CHORD EXTENSION

TYPICAL "CANOPY OVERHANG"